



## **UM 8003 Concentrate Trolley**

### **Instruction and spare parts**

|          |            |
|----------|------------|
| Edition  | 2025       |
| Revised  | 01.01.2025 |
| Language | ENG        |

Original user manual

## Warranty

This Underhaug product is warranted against manufacturing and material defects for a period of one year.

Components not manufactured by Underhaug, such as electrical and hydraulic equipment, power take-off (PTO) shafts, and tires, are covered according to the original manufacturer's warranty terms.

### Limited Warranty for Specific Components:

Due to their functional nature, the following components have limited warranty coverage:

Tires, blades, blade tips, shear bolts, fuses, and hydraulic seals in pumps, motors, valves, and cylinders, etc.

Wear and tear resulting from normal use is considered standard for these parts.

Warranty for these components is therefore limited to manufacturing defects such as breakage, deviations in design, or transport damage identified on new machines.

If damage is believed to be covered under the product warranty, the owner or the owner's representative must inform the dealer when requesting parts or repair work. Warranty claims must be reported within the warranty period.

The dealer must complete a claim form for each warranty case and submit it to Underhaug's sales company/importer by the 10th of the month following the report of the damage.

Damaged parts must be labelled with the claim number and retained for up to six months to allow Underhaug's sales company/importer to inspect them.

As the use of Underhaug products occurs outside the manufacturer's control, we can only guarantee the product's quality, not its performance or any resulting damages.

### Warranty Exclusions:

The warranty may be voided if:

- a) non-original spare parts are used, or the product is repaired or modified without Underhaug's approval.
- b) The manufacturer's operating and service instructions are not followed.
- c) The machine is used for purposes other than those intended.

The warranty does not cover damage caused by wear and tear.

Public safety regulations require the manufacturer of this machine to carefully assess the safety of its correct use. Therefore, Underhaug and our importer/sales company cannot be held responsible for the function of components not listed in the spare parts catalogue for this product.

Underhaug reserves the right to make design changes without obligation to update previously delivered machines.



# Contents

|   |                 |
|---|-----------------|
| <b>General Safety .....</b>               | <b>pg. 4-8</b>  |
| <b>Supplementary Safety .....</b>         | <b>pg. 9</b>    |
| <b>Machine Applications .....</b>         | <b>pg.10-12</b> |
| <b>Spare Parts .....</b>                  | <b>pg.13-20</b> |
| <b>EU Declaration of Conformity .....</b> | <b>pg. 21</b>   |

## Safety

### Before operating the machine

Before operating, adjusting, or repairing the machine, the user, repairer, and owner must familiarize themselves with the safety instructions provided in this manual (Fig 1). Be attentive and cautious when working with agricultural machinery. Read and take note of the safety instructions in this manual.

Safety at work is your responsibility

### General safety instructions

Exercise caution when other people or animals are nearby

Never start the machine when people or animals are close to the machine and tractor. Never stand between the tractor wheels and the machine (Fig 2).

Be aware of regulations concerning the operation of agricultural machinery by minors.

### Using the machine

The machine should only be used for its intended purpose.

### Use personal protective equipment

Do not wear loose clothing that could get caught in moving parts of the machine. Use an approved mask in dusty working conditions (Fig 3).

Be aware of the dangers of high noise levels. Some tractor-implement-combinations may under certain conditions produce noise levels above 85 dB, even inside soundproofed cabs. In such cases, hearing protection must be used. Keep the tractor's

windows and doors closed to reduce the noise level around the driver

### Ensure proper tractor compatibility

The tractor's weight must match the machine's maximum working weight. Follow applicable public regulations (Fig 4).

Verify that the correct PTO gear ratio is connected. A machine designed for 540 RPM must never be connected to a tractor with a 1000 RPM. PTO engaged the machine's standard. PTO speed is indicated on a label near the power transmission system.

### Important safety symbol



Pay special attention to this symbol. It indicates a safety hazard and outlines precautions to avoid accidents.

This symbol may appear throughout this manual and on warning labels on the machine. They are there for your safety and must be noted.

### Connecting the tractor and machine

Always follow the instructions in the manual when connecting the machine. If the connection is made by an agricultural hitch, one part (tractor or machine hitch) must have a clevis design. The hitch pin must be secured with a locking pin (Fig 5).

### Follow applicable regulations for road transport

Some countries require the use of safety chains when transporting a towed machine.

**Think safety while working**

The tractor engine should be stopped and the ignition key removed before performing any repair work, lubrication, or other maintenance on the machine. (Fig. 6).

**Protective covers**

Ensure that all covers are in good condition and properly mounted. Do not attempt to start the machine until this has been done. Damaged covers should be repaired or replaced immediately. (Fig. 7). Pay special attention to all protective covers related to the power take-off shafts. Replace damaged covers. Safety chains must always be attached to the machine and/or tractor to prevent the protective sleeves from rotating.

**Hydraulics**

Be cautious when handling hydraulic systems. Wear eye protection and gloves. Oil released under high pressure can penetrate the skin and cause serious internal damage. Seek medical attention if you have been exposed to such injury. (Fig. 8).

**Ensure that no one is near the machine when hydraulic functions are operated.**

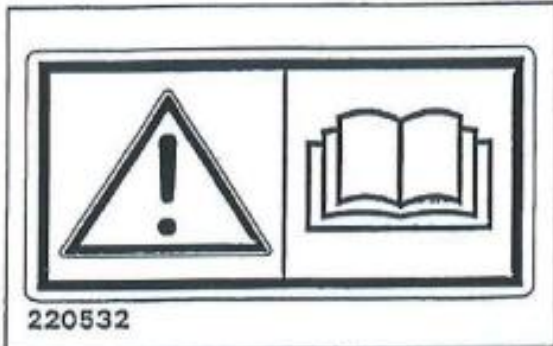

Fig. 1

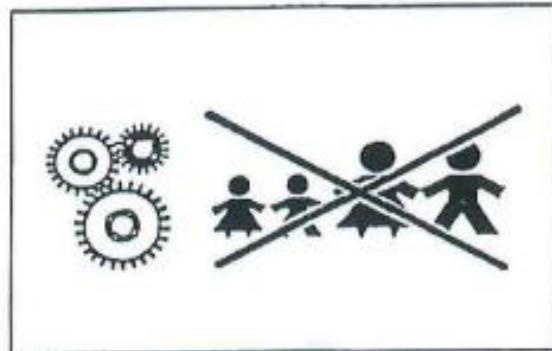

Fig. 2



Fig. 3

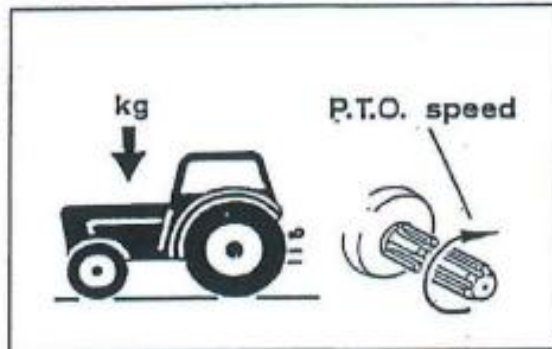

Fig. 4

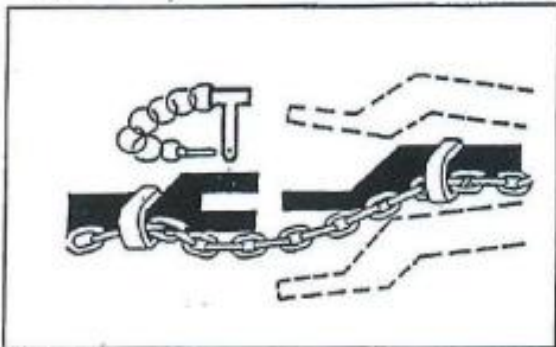

Fig. 5

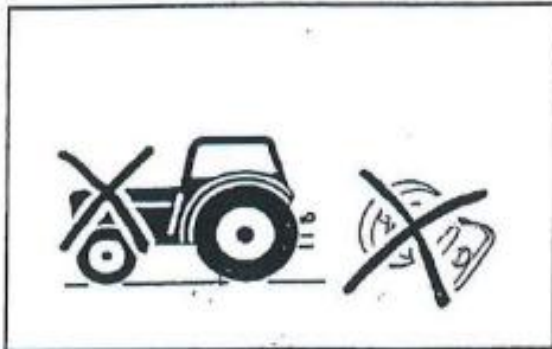

Fig. 6

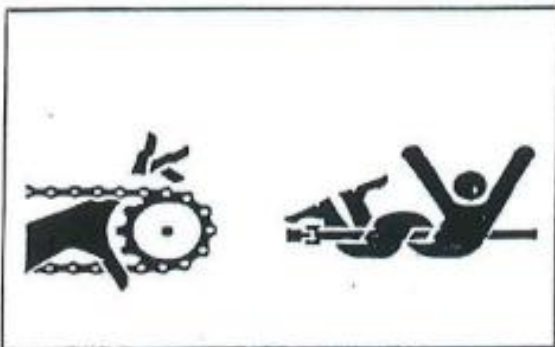

Fig. 7



Fig. 8

### **When disconnecting the machine and leaving the tractor/machine**

Set all hydraulic functions to the neutral position when disconnecting the machine. Lower the movable working components to the ground or set them in the transport position and secure them. If the machine is equipped with parking blocks, these should be used. Do not allow children to play or remain near agricultural machines. (Fig. 9).

### **Drive Safely**

Remember, you are responsible – carelessness and negligence can cause serious injury or even death. (Fig. 10).

### **Check the wheel bolts and the connection**

between the machine and tractor before transport on public roads. Also disconnect the hydraulic system.

Drive carefully. Reduce speed in turns and when driving on uneven surfaces. Ensure that the towed machine does not move uncontrollably sideways.

Be aware of the tipping hazard when driving on slopes and on soil with low bearing capacity. Reduce the load.

### **Lights**

The owner/operator is responsible for equipping the machine with the correct sound and reflectors when driving on public roads. Follow public regulations. (Fig. 11).

### **Safety equipment**

Always carry first aid equipment in the tractor. Follow public regulations regarding fire extinguishing equipment. When working with flammable materials such as hay and straw, fire extinguishing equipment must always be available. (Fig. 12).

### **Spare parts**

For safety reasons, we recommend using only original spare parts. The product warranty is invalid if non-original parts are used. (Fig. 13).

### **Maintenance**

Ensure that the machine is properly maintained and kept in good condition. Never make modifications to the machine's technical design. (Fig. 14).



Fig. 9

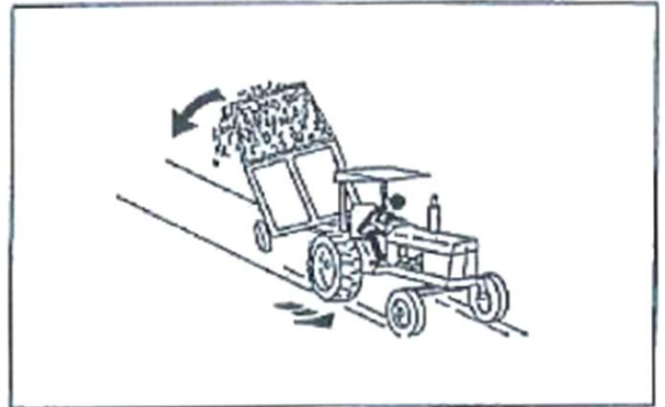

Fig. 10

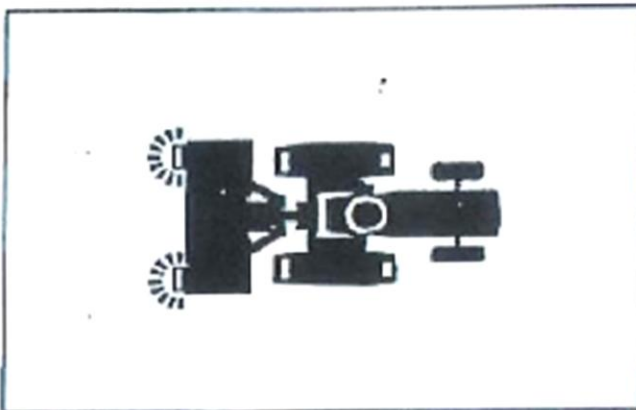

Fig. 11

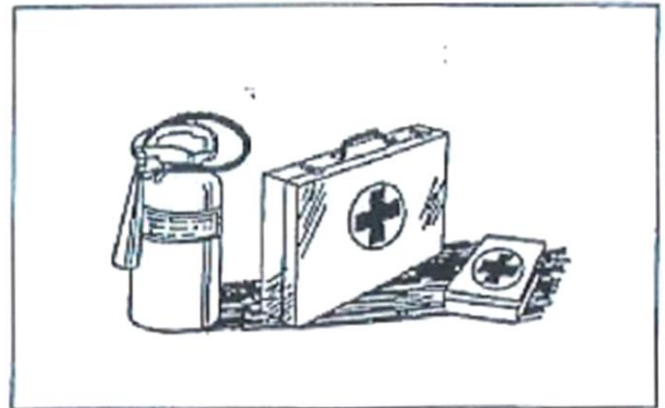

Fig. 12

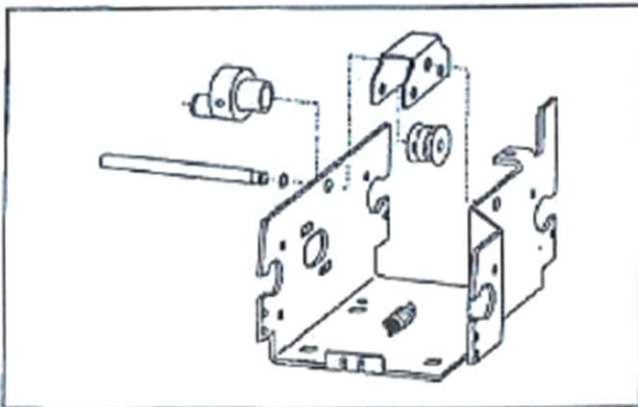

Fig. 13



Fig. 14

## Instructions for Underhaug UM 8803 Concentrate Trolley

This equipment is primarily designed to portion out various types of feed accurately for cows, pigs, sheep, etc.

The feed wagon is marked with this  warning sign. If the sign is damaged, it must be replaced. Warning sign 220532 (fig. 1).

Remember! Read and understand the instruction manual before using the equipment and before adjusting and performing maintenance.



220532

Fig. 1

### Machine Identification

The machine's serial number and the manufacturer's address are indicated on a plate on the machine. See illustration on this page.

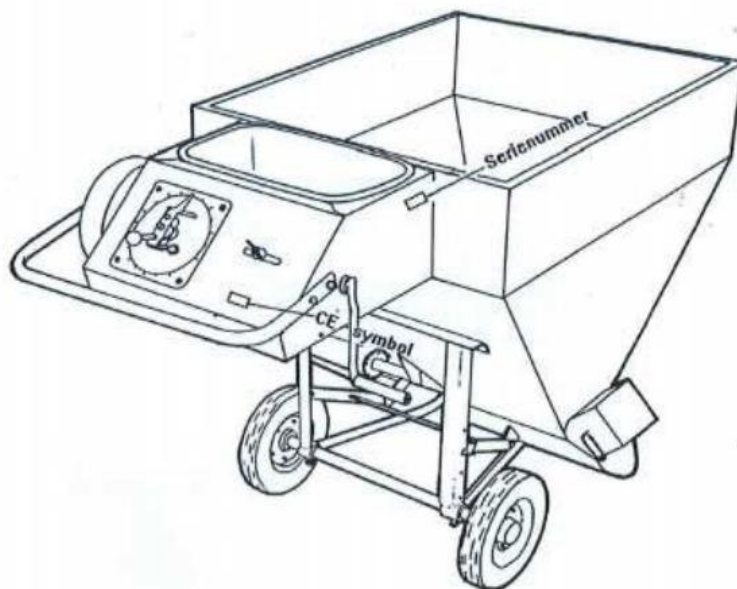

## Operating range

A feed auger at the bottom of the container feeds the feed out. The screw is driven by a crank on the right side of the wagon, using a standard bicycle chain drive.

## Adjustment of wagon height – adjustment for the trough

The wagon is delivered from the factory set to the lowest height, with a total height of 93 cm and 15 cm from the floor to the bottom of the outlet nozzle. This height can be adjusted to suit the height of the trough. The container is attached to the wheel assembly with 3 angle iron stands, which can be extended with 35 cm extension pieces. The height can be adjusted in 5 cm increments up to 50 cm.



Fig. 1 Assembly of frame, extension rails, and fastening rods.

If the trough has a wide edge, the wheel axle can be shifted slightly to the left, a maximum of 4.5 cm. This allows the outlet nozzle to extend further into the trough.

## Height adjustment of the handle

When the wagon is set at higher heights, the working position can be improved by lowering the handle. This is done by loosening the front fastening screw on the left side of the handle and both screws on the right side. The handle is then pressed downwards and fastened again. (See fig. 2)

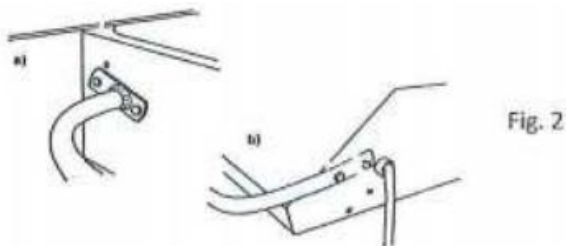

Fig. 2 Height adjustment of the handle.

a) Left side fastening

b) Right side fastening

## **Adjustment of the weight scale**

The feed mechanism is based on the volume portioning principle. With equal movement of the screw, the same volume of feed is dispensed, even if the weight of the feed varies. To ensure that the weight scale shows the correct weight, the pointer is driven through a variable transmission. This variator must be adjusted according to the feed being used.

To do this:

Loosen the nut on the right side of the scale. By shifting this position, set the pointer (the groove in the feed screw) to the horizontal calibration scale at 4.0 kg. Reset the main pointer and dispense feed until this pointer reaches 4.0 kg. The dispensed amount of feed is weighed. Adjust the calibration scale to the number that corresponds to the weighed amount.

The dispensing mechanism is now adjusted and will show the correct weight if the weight of the feed does not change. If the feed becomes lighter or heavier due to a change in the feed mixture, or a different feed is used, the scale must be adjusted again. It is recommended to check the weight regularly.

## **Discharge spout hatch**

This can be locked in the closed position to prevent feed spillage during transport.

## **Maintenance**

The air wheels have maintenance-free ball bearings. The pivot pin on the fork wheel has a grease nipple and must be lubricated periodically. All other bearings are made of nylon and should receive a few drops of oil from time to time.

## **Troubleshooting**

Malfunctions can occur in the vehicle's drive mechanism. This mechanism is simple in construction, and the fault is generally easy to repair with only common sense and basic tools.

If a fault occurs, it is almost exclusively related to the drive mechanism of the pointer. The fault appears when the screw dispenses feed normally while the pointer remains stationary or moves in jerks.

To address this, remove the extra container and loosen the spring (ref. no. 1 / fig. 3) from the sleeve (ref. no. 2). Then, rotate the pointer and check if it runs smoothly. If the movement is sluggish, add a few drops of oil to the bearing housings (ref. no. 3 and 4).

If there is wobble in the disk on the pointer shaft (ref. no. 5), try to straighten it. Check if the drive wheel (ref. no. 6) runs smoothly. If needed, add a few drops of oil to the hub. If this doesn't help, remove the cotter pin (ref. no. 7), pull out the shaft (ref. no. 8), and lower the wheel hub by approximately 1 mm.

Make sure the disk on the pointer shaft is clean and free of dirt and rust.

If the handle/crank is hard to turn, it is usually because the piping moves heavily. Do not apply more movement to the piping than necessary.

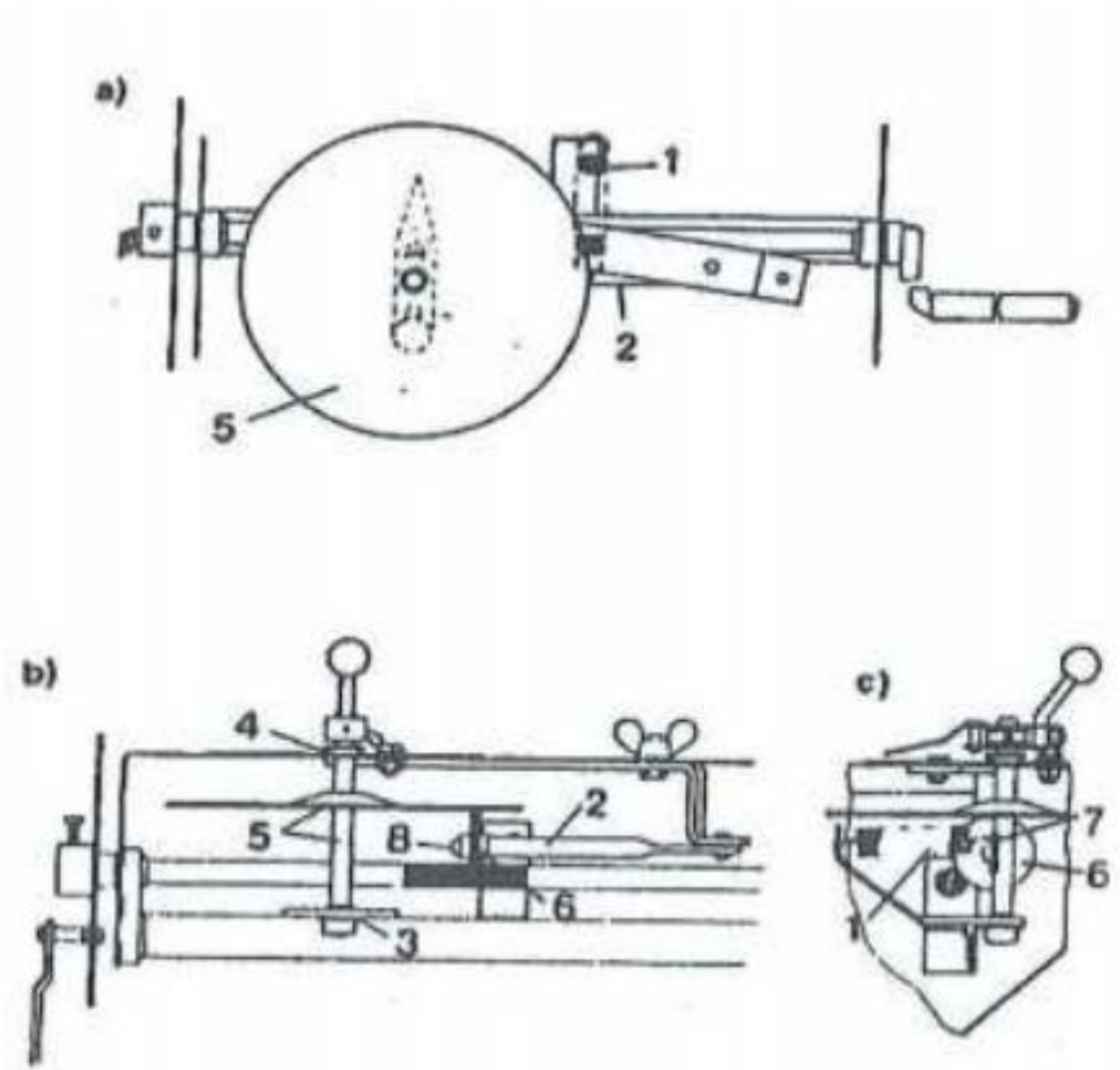
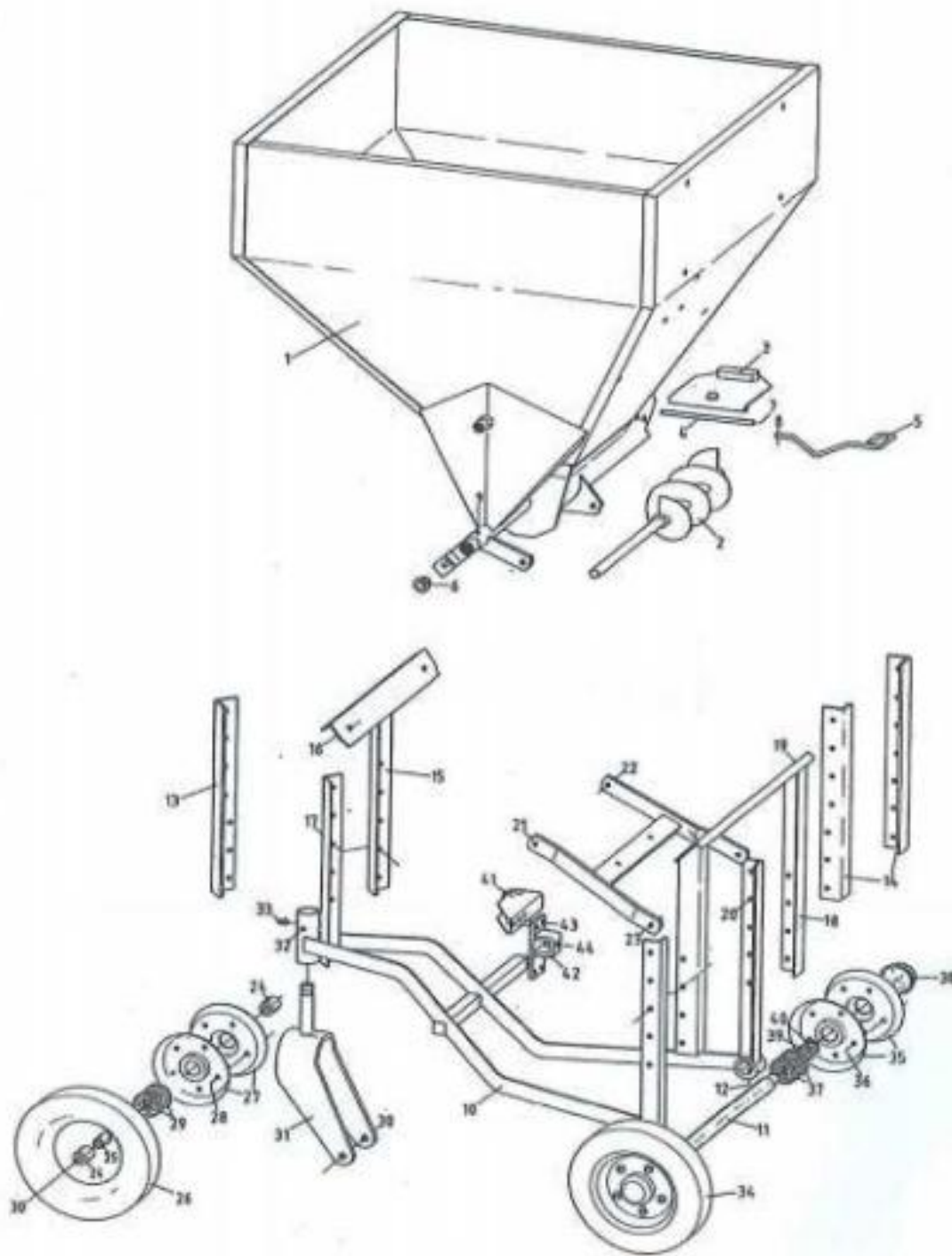

Fig. 3 The wagon's drive mechanism

- a) View from above
- b) View from behind
- c) View from the left side

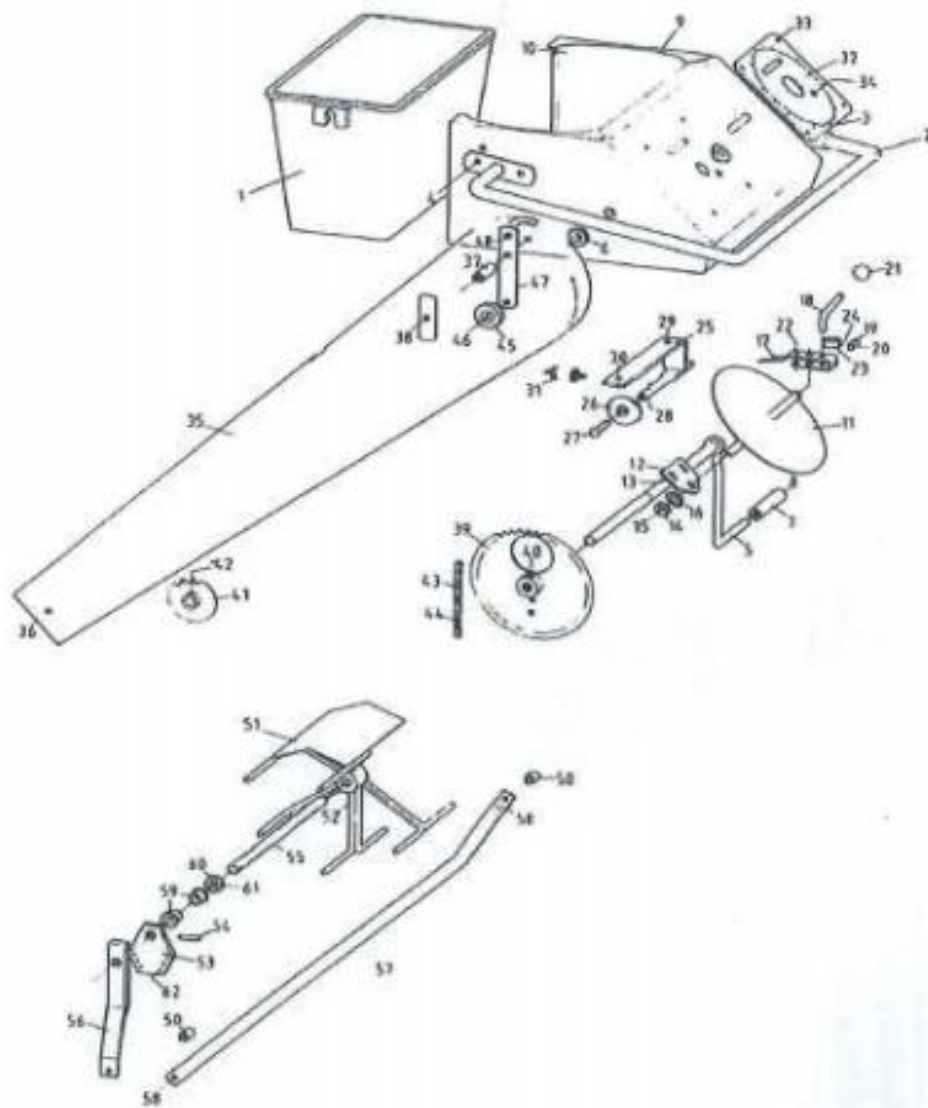

**Fig. 1**

**SPARE PARTS FIG. 1: CONTAINER AND WHEEL SYSTEM**

| <b>Ref.</b> | <b>Part No.</b> | <b>Quantity</b> | <b>Item</b>                         |
|-------------|-----------------|-----------------|-------------------------------------|
| 1-9         | 240951          | 1               | Container COMPLETE                  |
| 1           | 240952          | 1               | Container                           |
| 2           | 240971          | 1               | Feed screw                          |
| 3           | 240975          | 1               | Lid                                 |
| 4           | 241075          | 1               | Lid bolt                            |
| 5           | 241076          | 1               | Lid lock                            |
| 6           | 241090          | 2               | Bearing sleeve Ø16                  |
| 7           | 860156          | 2               | Support washer 6 GALV               |
| 8           | 865164          | 1               | Cotter pin 3.2x14 GALV              |
| 9           | 873506          | 1               | Oil cup Ø6                          |
| 10          | 241301          | 1               | Frame                               |
| 11          | 241303          | 1               | Axle                                |
| 12          | 817619          | 2               | Hex screw 1/2" x19-8.8              |
| 13          | 241320          | 1               | Extension rail                      |
| 14          | 241321          | 2               | Extension rail                      |
| 15          | 241322          | 1               | Fixing bar                          |
| 16          | 821420          | 2               | Locking screw M8x20-4.6 GALV        |
| 16          | 231499          | 2               | Support washer GALV                 |
| 16          | 850158          | 2               | Hex nut M8 GALV                     |
| 17          | 813420          | 2               | Hex screw M8x20-8.8 GALV            |
| 17          | 850158          | 2               | Hex nut M8 GALV                     |
| 18          | 241325          | 1               | Fixing rods                         |
| 19          | 821420          | 2               | Locking screw M8x20-8.8 GALV        |
| 19          | 231499          | 2               | Support washer GALV                 |
| 19          | 850158          | 2               | Hex nut M8 GALV                     |
| 20          | 813420          | 2               | Hex screw M8x20-8.8 GALV            |
| 20          | 850158          | 2               | Hex nut M8 GALV                     |
| 21          | 241329          | 1               | Fork                                |
| 22          | 813425          | 2               | Hex screw M8x25-8.8 GALV            |
| 22          | 850158          | 2               | Hex nut M8 GALV                     |
| 23          | 813430          | 2               | Hex screw M8x30-8.8 GALV            |
| 23          | 850158          | 2               | Hex nut M8 GALV                     |
| 24          | 241347          | 1               | Fork wheel SKG/250 COMPLETE         |
| 24          | 241347          | 2               | Bearing OUT OF STOCK                |
| 25          | 241349          | 1               | Smaller bearing OUT OF STOCK        |
| 26          | 241336          | 1               | Rubber wheel COMPLETE. OUT OF STOCK |
| 26          | 241344          | 1               | Rubber ring OUT OF STOCK            |
| 27          | 241345          | 2               | Rim plate OUT OF STOCK              |

| Ref. | Part No. | Quantity | Item                                      |
|------|----------|----------|---|
| 28   | 813312   | 5        | Hex screw M6x12-8.8 GALV OUT OF STOCK     |
| 29   | 870722   | 2        | Ball bearing 6204-2RS OUT OF STOCK        |
| 30   | 850363   | 1        | Hex screw 1/2" x114-8.8 GALV OUT OF STOCK |
| 31   | 241335   | 1        | Wheel fork OUT OF STOCK                   |
| 32   | 838308   | 1        | Pan screw with groove 1/4"x8 GALV         |
| 33   | 873520   | 1        | Grease nipple 1/4" UNF                    |
| 34   | 241343   | 2        | End wheels SKE/250 COMPLETE. OUT OF STOCK |
| 34   | 241336   | 1        | Rubber wheel COMPLETE. OUT OF STOCK       |
| 34   | 241344   | 1        | Rubber ring OUT OF STOCK                  |
| 35   | 241345   | 2        | Rim plate OUT OF STOCK                    |
| 36   | 813312   | 5        | Hex screw M6x12-8.8 GALV OUT OF STOCK     |
| 36   | 850156   | 5        | Hex nut M6 GALV OUT OF STOCK              |
| 37   | 870722   | 2        | Ball bearing 6204-2RS OUT OF STOCK        |
| 38   | 241350   | 1        | Capsule OUT OF STOCK                      |
| 39   | 868604   | 1        | Support ring SS20x28x2.0 OUT OF STOCK     |
| 40   | 868420   | 1        | Lock ring A20x1.20 OUT OF STOCK           |
| 41   | 241380   | 1        | Steering wheel COMPLETE. OUT OF STOCK     |
| 41   | 241381   | 1        | Steering wheel OUT OF STOCK               |
| 42   | 241382   | 1        | Steering wheel holder OUT OF STOCK        |
| 43   | 813416   | 2        | Hex screw M8x16-8.8 GALV OUT OF STOCK     |
| 43   | 850158   | 2        | Hex nut M8 GALV OUT OF STOCK              |
| 44   | 813516   | 1        | Hex screw M10x16-8.8 GALV OUT OF STOCK    |
|      | 8012     |          | Air wheel set for old wagons              |
|      | 241281   |          | Wheel fork for 4.00x4                     |
|      | 241285   |          | Wheel 4.00x4 COMPLETE EK                  |
|      | 241286   |          | Wheel 4.00x4 COMPLETE GK                  |
|      | 241290   |          | Wheel axle                                |
|      | 241295   |          | Brake plate for pellets                   |



**Fig. 2**

**SPARE PARTS FIG.2: DRIVE AND MIXING SYSTEM**

| <b>Ref.</b> | <b>Part No.</b> | <b>Qty</b> | <b>Item</b>                          |
|-------------|-----------------|------------|--------------------------------------|
| 1           | 241269          | 1          | Extra container                      |
| 2-34        | 241401          | 1          | Drive system COMPLETE                |
| 2           | 241149          | 1          | Handle                               |
| 3           | 813412          | 2          | Hex. screw M8x12-8,8 GALV            |
| 3           | 850158          | 2          | Hex. nut M8 GALV                     |
| 4           | 813416          | 2          | Hex. screw M8x16-8,8 GALV            |
| 4           | 850158          | 2          | Hex. nut M8 GALV                     |
| 5           | 241415          | 1          | Crank                                |
| 6           | 241090          | 2          | Bearing liner Ø16                    |
| 7           | 241173          | 1          | Crank sleeve                         |
| 8           | 838308          | 1          | Pan screw with slot 1/4" x8<br>GALV  |
| 9           | 241403          | 1          | Box                                  |
| 10          | 813412          | 4          | Hex. screw M8x12-8,8 GALV            |
| 10          | 850185          | 4          | Hex. nut M8 GALV                     |
| 11          | 241437          | 1          | Pointer shaft                        |
| 12          | 241437          | 1          | Bearing plate                        |
| 13          | 813420          | 2          | Hex. screw M8x20-8,8 GALV            |
| 13          | 860158          | 2          | Underlay washer 8 GALV               |
| 13          | 850158          | 2          | Hex. nut M8 GALV                     |
| 14          | 241435          | 1          | Stop ring                            |
| 15          | 866274          | 1          | Tension sleeve 5x24x1,0              |
| 16          | 240191          | 2          | Bearing liner Ø12                    |
| 17-22       | 241428          | 1          | Pointer COMPLETE                     |
| 17          | 241429          | 1          | Pointer                              |
| 18          | 241430          | 1          | Arm                                  |
| 19          | 241431          | 1          | Pal                                  |
| 20          | 866220          | 1          | Tension sleeve 4x20x0,8              |
| 21          | 241432          | 1          | Ball Ø25                             |
| 22          | 838319          | 1          | Pan screw with slot 1/4" x19<br>GALV |
| 23          | 241436          | 1          | Stop ring                            |

| <b>Ref.</b> | <b>Part No.</b> | <b>Qty</b> | <b>Item</b>                              |
|-------------|-----------------|------------|--|
| 24          | 832010          | 1          | Threaded pin with hex hole<br>1/4"x6     |
| 25+26-28    | 241420          | 1          | Drive wheel COMPLETE                     |
| 26          | 241424          | 1          | Wheel                                    |
| 27          | 241424          | 1          | Axle                                     |
| 28          | 865220          | 1          | Pin 4x20 GALV                            |
| 29          | 817525          | 1          | Hex. nut 3/8" x 25-8,8 GALV              |
| 29          | 855360          | 1          | Wing nut 3/8" GALV                       |
| 29          | 860160          | 1          | Underlay washer 10 GALV                  |
| 30          | 838319          | 1          | Pan screw with slot 1/4" GALV            |
| 31          | 241438          | 1          | Spring                                   |
| 32          | 241445          | 1          | Scale                                    |
| 33          | 850155          | 4          | Hex. nut M5 GALV                         |
| 33          | 860135          | 4          | Underlay washer for<br>countersunk screw |
| 34          | 813416          | 1          | Hex. screw M8x16-8,8 GALV                |
| 34          | 860158          | 2          | Underlay washer 8 GALV                   |
| 34          | 850158          | 1          | Hex. nut M8 GALV                         |
| 35-48       | 240978          | 1          | Chain drive COMPLETE                     |
| 35          | 240979          | 1          | Shield                                   |
| 36          | 821420          | 1          | Locking screw M8x20-4,6 GALV             |
| 36          | 850158          | 1          | Hex. nut M8 GALV                         |
| 36          | 860158          | 1          | Underlay washer 8 GALV                   |
| 37          | 240982          | 1          | Spacer sleeve                            |
| 38          | 817570          | 1          | Hex. screw 3/8" x70-8,8 GALV             |
| 38          | 850360          | 1          | Hex. nut M8 GALV                         |
| 39          | 241202          | 1          | Sprocket 1/2" x1/8" 46t                  |
| 40          | 830625          | 1          | Set screw 4-kt 1/2" UNCx25               |
| 41          | 241206          | 1          | Sprocket 1/2" x 1/8" 18t                 |
| 42          | 866274          | 1          | Tension sleeve 5x24x1,0                  |
| 43+44       | 241231          | 1          | Chain 1/2"x1/8"x2273                     |
| 44          | 901402          | 1          | Chain lock 1/2"x1/8"                     |
| 45          | 241238          | 1          | Tension roller                           |

| <b>Ref.</b> | <b>Part No.</b> | <b>Qty</b> | <b>Item</b>                                 |
|-------------|-----------------|------------|---|
| 46          | 813440          | 1          | Hex. screw M8x40-8,8 GALV                   |
| 46          | 850158          | 1          | Hex. nut M8 GALV                            |
| 47          | 241239          | 1          | Roller arm                                  |
| 48          | 821420          | 1          | Locking screw M8x20-4,6                     |
| 48          | 860158          | 1          | Underlay washer 8 GALV                      |
| 48          | 850158          | 1          | Hex. nut M8 GALV                            |
| 49          | 22003           | 1          | Hex. key 1/8" NV                            |
| 50-61       | 8014            | 1          | Mixing system DISCONTINUED                  |
| 50          | 240983          | 2          | Spacer sleeve DISCONTINUED                  |
| 51          | 241078          | 1          | Mixer DISCONTINUED                          |
| 52          | 816619          | 1          | Hex. screw 1/2"x19-8,8 GALV<br>DISCONTINUED |
| 53          | 241084          | 1          | Crank plate DISCONTINUED                    |
| 54          | 241092          | 1          | Pin DISCONTINUED                            |
| 55          | 241085          | 1          | Axle DISCONTINUED                           |
| 56          | 241086          | 1          | Crank arm DISCONTINUED                      |
| 57          | 241087          | 1          | Crank rod DISCONTINUED                      |
| 58          | 817544          | 2          | Hex. screw 3/8"x44-8,8 GALV<br>DISCONTINUED |
| 58          | 850360          | 4          | Hex. nut 3/8" GALV<br>DISCONTINUED          |
| 59          | 241090          | 2          | Bearing liner Ø16<br>DISCONTINUED           |
| 60          | 241167          | 1          | Stop ring DISCONTINUED                      |
| 61          | 830310          | 1          | Set screw 4kt. 1/4"x10<br>DISCONTINUED      |
| 62          | 867014          | 2          | Spring pin 4,0x75 GALV<br>DISCONTINUED      |

**Numerisk deleregister/ Numerical parts index**

| Delenummer<br>Part number | Delenummer<br>Page/ Ref. nr. |
|---------------------------|------------------------------|
| 8011                      | 3/ 10-44                     |
| 8014                      | 7/ 50-61                     |
| 220003                    | 7/49                         |
| 231499                    | 3/16                         |
| 240951                    | 3/ 1-9                       |
| 240952                    | 3/1                          |
| 240971                    | 3/2                          |
| 240975                    | 3/3                          |
| 240978                    | 5/ 2-34                      |
| 240979                    | 5/35                         |
| 240982                    | 5/37                         |
| 240983                    | 7/50                         |
| 241075                    | 3/4                          |
| 241076                    | 3/5                          |
| 241078                    | 7/51                         |
| 241084                    | 7/53                         |
| 241085                    | 7/55                         |
| 241086                    | 7/56                         |
| 241087                    | 7/57                         |
| 241090                    | 3/6                          |
| 241091                    | 5/16                         |
| 241092                    | 7/54                         |
| 241149                    | 5/2                          |
| 241167                    | 7/60                         |
| 241173                    | 5/7                          |
| 241202                    | 5/39                         |
| 241206                    | 5/41                         |
| 241231                    | 7/ 43+44                     |
| 241238                    | 7/45                         |
| 241239                    | 7/47                         |
| 241269                    | 5/1                          |
| 241301                    | 3/10                         |
| 241303                    | 3/11                         |
| 241320                    | 3/13                         |
| 241321                    | 3/14                         |
| 241322                    | 3/15                         |
| 241325                    | 3/18                         |
| 241329                    | 3/21                         |
| 241335                    | 3/31                         |
| 241336                    | 3/ 26-29                     |
| 241342                    | 3/ 24-30                     |
| 241343                    | 3/ 34-40                     |
| 241344                    | 3/26                         |
| 241345                    | 3/27                         |
| 241347                    | 3/24                         |
| 241349                    | 3/25                         |
| 241350                    | 3/38                         |
| 241380                    | 3/ 41-44                     |
| 241381                    | 3/41                         |
| 241382                    | 3/42                         |

| Delenummer<br>Part number | Delenummer<br>Page/ Ref. nr. |
|---------------------------|------------------------------|
| 241403                    | 5/9                          |
| 241412                    | 5/11                         |
| 241415                    | 5/5                          |
| 241420                    | 5/ 25+26 - 28                |
| 241421                    | 5/26                         |
| 241424                    | 5/27                         |
| 241428                    | 5/ 17-22                     |
| 241429                    | 5/17                         |
| 241430                    | 5/18                         |
| 241431                    | 5/19                         |
| 241432                    | 5/21                         |
| 241435                    | 5/14                         |
| 241436                    | 5/23                         |
| 241437                    | 5/12                         |
| 241438                    | 5/31                         |
| 241445                    | 5/32                         |
| 813312                    | 3/28                         |
| 813412                    | 5/3                          |
| 813416                    | 3/17                         |
| 813420                    | 5/13                         |
| 813425                    | 3/22                         |
| 813430                    | 3/23                         |
| 813440                    | 7/46                         |
| 813516                    | 3/44                         |
| 816619                    | 7/52                         |
| 817525                    | 5/29                         |
| 817544                    | 7/58                         |
| 817570                    | 5/38                         |
| 817601                    | 3/30                         |
| 817619                    | 3/12                         |
| 821420                    | 3/16                         |
| 830310                    | 7/61                         |
| 830625                    | 5/40                         |
| 832010                    | 5/24                         |
| 838308                    | 3/32                         |
| 838319                    | 5/22                         |
| 839260                    | 5/33                         |
| 850155                    | 5/33                         |
| 150156                    | 3/28                         |
| 150158                    | 3/16                         |
| 150158                    | 3/16                         |
| 850356                    | 3/16                         |
| 150156                    | 3/28                         |
| 150158                    | 3/16                         |
| 150158                    | 3/16                         |
| 850356                    | 3/16                         |
| 850360                    | 5/38                         |
| 850363                    | 3/30                         |
| 855360                    | 5/29                         |
| 860135                    | 5/33                         |

| Delenummer<br>Part number | Delenummer<br>Page/ Ref. nr. |
|---------------------------|------------------------------|
| 860155                    | 5/8                          |
| 860156                    | 3/7                          |
| 860158                    | 5/13                         |
| 860160                    | 5/29                         |
| 865164                    | 3/8                          |
| 865220                    | 5/28                         |
| 866220                    | 5/20                         |
| 866274                    | 5/15                         |
| 867014                    | 7/62                         |
| 868420                    | 3/40                         |
| 868604                    | 3/39                         |
| 870722                    | 3/29                         |
| 873506                    | 3/9                          |
| 873520                    | 3/33                         |
| 901402                    | 7/44                         |



## EU - DECLARATION OF CONFORMITY

### Responsible person

|          |                                       |
|----------|---------------------------------------|
| Name     | Atle Årslund                          |
| Position | General Manager                       |
| Company  | Underhaug AS                          |
| Address  | Torlandsvegen 3<br>4365 Nærbø, NORWAY |
| Phone    | +47 51 43 49 78                       |

### Declares that the following machine:

|                  |                             |
|------------------|-----------------------------|
| Manufacturer:    | Underhaug AS                |
| Type:            | UM 8003 Concentrate Trolley |
| erial Number:    |                             |
| Production Year: |                             |

complies with the following directive:

Maximum regulation 554 (for 2009-05-20-554) and meets essential health and safety requirements.

Basic standard ISO 12100

A handwritten signature in blue ink, appearing to read "Atle Årslund", positioned above a horizontal line.

Atle Årslund

Nærbø, date



Torlandsvegen 3 – P.Box 183

N-4367 Nærbø, Norway

Phone: +47 51 43 49 78

Email: [post@underhaug.no](mailto:post@underhaug.no)

[www.underhaug.no/eng](http://www.underhaug.no/eng)