



UM 7705 Round Bale Handler

Instruction and spare parts

Edition	2025
Revised	01.01.2025
Language	ENG

Original user manual

Warranty

This Underhaug product is warranted against manufacturing and material defects for a period of one year.

Components not manufactured by Underhaug, such as electrical and hydraulic equipment, power take-off (PTO) shafts, and tires, are covered according to the original manufacturer's warranty terms.

Limited warranty for specific components

Due to their functional nature, the following components have limited warranty coverage:

Tires, blades, blade tips, shear bolts, fuses, and hydraulic seals in pumps, motors, valves, and cylinders, etc.

Wear and tear resulting from normal use is considered standard for these parts.

Warranty for these components is therefore limited to manufacturing defects such as breakage, deviations in design, or transport damage identified on new machines.

If damage is believed to be covered under the product warranty, the owner or the owner's representative must inform the dealer when requesting parts or repair work. Warranty claims must be reported within the warranty period.

The dealer must complete a claim form for each warranty case and submit it to Underhaug's sales company/importer by the 10th of the month following the report of the damage.

Damaged parts must be labelled with the claim number and retained for up to six months to allow Underhaug's sales company/importer to inspect them.

As the use of Underhaug products occurs outside the manufacturer's control, we can only guarantee the product's quality, not its performance or any resulting damages.

Warranty exclusions

The warranty may be voided if:

- a) non-original spare parts are used, or the product is repaired or modified without Underhaug's approval.
- b) The manufacturer's operating and service instructions are not followed.
- c) The machine is used for purposes other than those intended.

The warranty does not cover damage caused by wear and tear.

Public safety regulations require the manufacturer of this machine to carefully assess the safety of its correct use. Therefore, Underhaug and our importer/sales company cannot be held responsible for the function of components not listed in the spare parts catalogue for this product.

Underhaug reserves the right to make design changes without obligation to update previously delivered machines.



Contents

General Safety	pg. 4-8
Supplementary Safety	pg. 9
Machine Applications	pg.10-11
Spare Parts	pg.12-17
EU Declaration of Conformity	pg. 18

Safety

Before operating the machine

Before operating, adjusting, or repairing the machine, the user, repairer, and owner must familiarize themselves with the safety instructions provided in this manual (Fig 1). Be attentive and cautious when working with agricultural machinery. Read and take note of the safety instructions in this manual.

Safety at work is your responsibility

General safety instructions

Exercise caution when other people or animals are nearby

Never start the machine when people or animals are close to the machine and tractor. Never stand between the tractor wheels and the machine (Fig 2).

Be aware of regulations concerning the operation of agricultural machinery by minors.

Using the machine

The machine should only be used for its intended purpose.

Use personal protective equipment

Do not wear loose clothing that could get caught in moving parts of the machine. Use an approved mask in dusty working conditions (Fig 3).

Be aware of the dangers of high noise levels. Some tractor-implement-combinations may under certain conditions produce noise levels above 85 dB, even inside soundproofed cabs. In such cases, hearing protection must be used. Keep the tractor's

windows and doors closed to reduce the noise level around the driver

Ensure proper tractor compatibility

The tractor's weight must match the machine's maximum working weight. Follow applicable public regulations (Fig 4).

Verify that the correct PTO gear ratio is connected. A machine designed for 540 RPM must never be connected to a tractor with a 1000 RPM. PTO engaged the machine's standard. PTO speed is indicated on a label near the power transmission system.

Important safety symbol



Pay special attention to this symbol. It indicates a safety hazard and outlines precautions to avoid accidents.

This symbol may appear throughout this manual and on warning labels on the machine. They are there for your safety and must be noted.

Connecting the tractor and machine

Always follow the instructions in the manual when connecting the machine. If the connection is made by an agricultural hitch, one part (tractor or machine hitch) must have a clevis design. The hitch pin must be secured with a locking pin (Fig 5).

Follow applicable regulations for road transport

Some countries require the use of safety chains when transporting a towed machine.

Think safety while working

The tractor engine should be stopped and the ignition key removed before performing any repair work, lubrication, or other maintenance on the machine. (Fig. 6).

Protective covers

Ensure that all covers are in good condition and properly mounted. Do not attempt to start the machine until this has been done. Damaged covers should be repaired or replaced immediately. (Fig. 7). Pay special attention to all protective covers related to the power take-off shafts. Replace damaged covers. Safety chains must always be attached to the machine and/or tractor to prevent the protective sleeves from rotating.

Hydraulics

Be cautious when handling hydraulic systems. Wear eye protection and gloves. Oil released under high pressure can penetrate the skin and cause serious internal damage. Seek medical attention if you have been exposed to such injury. (Fig. 8).

Ensure that no one is near the machine when hydraulic functions are operated.



Fig. 1

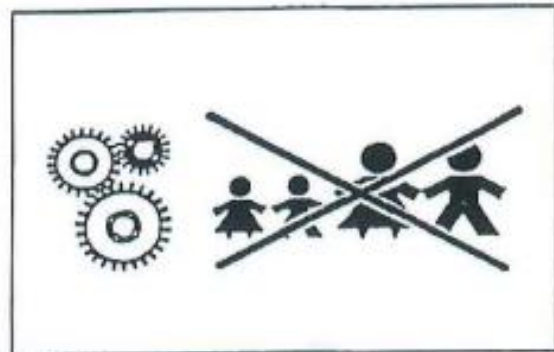

Fig. 2



Fig. 3

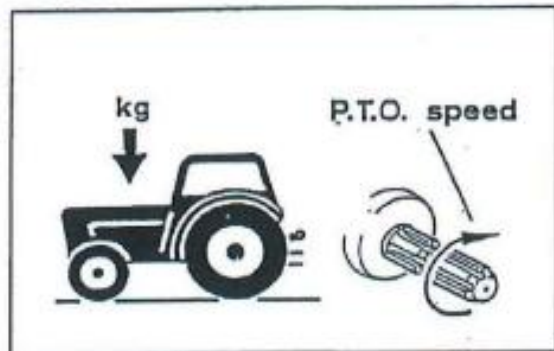

Fig. 4

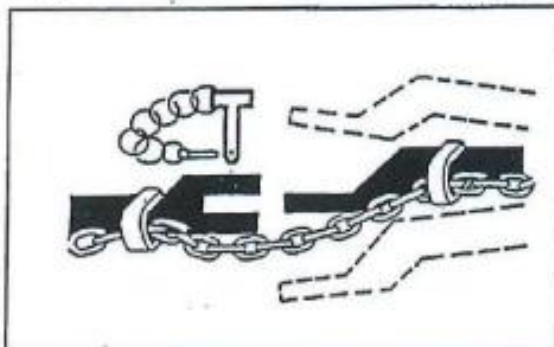

Fig. 5



Fig. 6

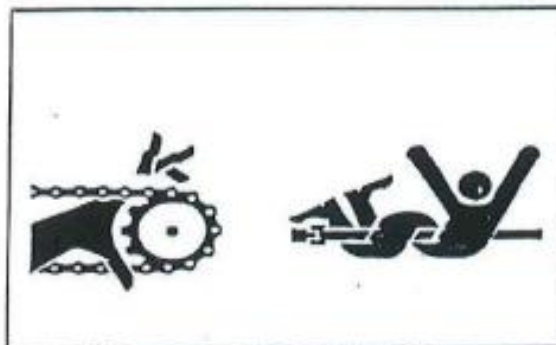

Fig. 7



Fig. 8

When disconnecting the machine and leaving the tractor/machine

Set all hydraulic functions to the neutral position when disconnecting the machine. Lower the movable working components to the ground or set them in the transport position and secure them. If the machine is equipped with parking blocks, these should be used. Do not allow children to play or remain near agricultural machines. (Fig. 9).

Drive Safely

Remember, you are responsible – carelessness and negligence can cause serious injury or even death. (Fig. 10).

Check the wheel bolts and the connection

between the machine and tractor before transport on public roads. Also disconnect the hydraulic system.

Drive carefully. Reduce speed in turns and when driving on uneven surfaces. Ensure that the towed machine does not move uncontrollably sideways.

Be aware of the tipping hazard when driving on slopes and on soil with low bearing capacity. Reduce the load.

Lights

The owner/operator is responsible for equipping the machine with the correct sound and reflectors when driving on public roads. Follow public regulations. (Fig. 11).

Safety equipment

Always carry first aid equipment in the tractor. Follow public regulations regarding fire extinguishing equipment. When working with flammable materials such as hay and straw, fire extinguishing equipment must always be available. (Fig. 12).

Spare parts

For safety reasons, we recommend using only original spare parts. The product warranty is invalid if non-original parts are used. (Fig. 13).

Maintenance

Ensure that the machine is properly maintained and kept in good condition. Never make modifications to the machine's technical design. (Fig. 14).



Fig. 9

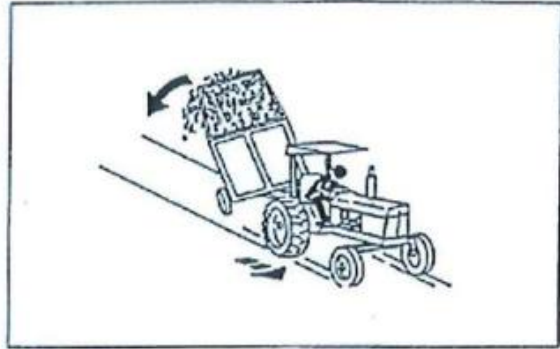

Fig. 10

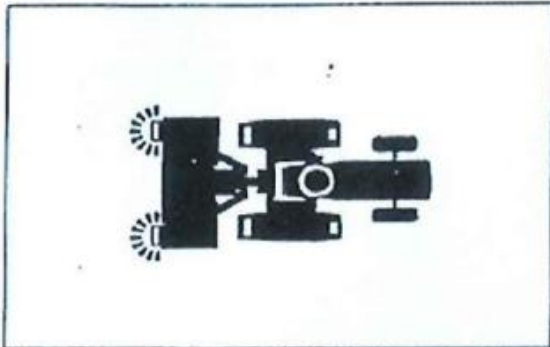

Fig. 11

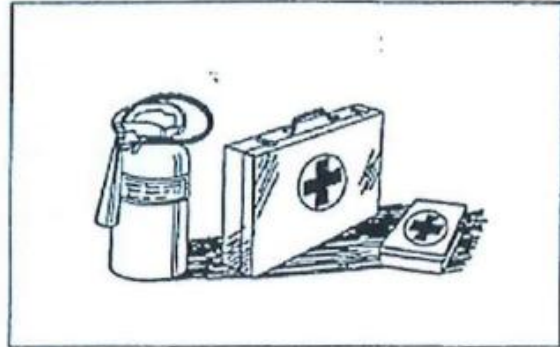

Fig. 12

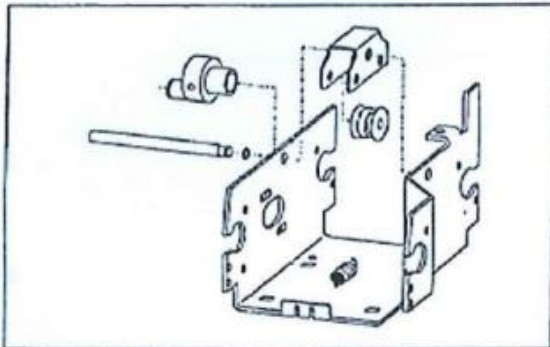



Fig. 13



Fig. 14

Instructions for UM 7705 Round bale handler

This equipment is marked with this  warning sign. If the sign is damaged, it must be replaced. Warning sign 220532 (fig. 1). Remember! Read and understand the instruction manual before using the equipment and before adjusting and performing maintenance.

Warning Sign 220532 (Fig. 1). Caution. Read and understand the instruction manual before using the equipment, and before adjusting or performing maintenance.

Warning Sign 220538 (Fig. 2). Due to the high risk of crushing, it is essential to keep people at a safe distance when the equipment is in use.

Warning Sign 220537 (Fig. 3). When the equipment is mounted on the rear of the tractor or on a loader, ensure no one walks underneath the equipment. Also, avoid lifting the equipment too high, as this may cause the load to fall off or the tractor to tip over.



Fig. 1



Fig. 2



Fig. 3

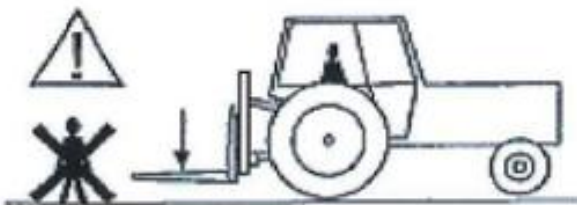

Technical Data	
Weight:	185 kg
Length:	1450 mm
Maximum width:	1900 mm (grabbing arms in outer position)
Height:	700 mm
Grabbing arm length:	1100 mm
Lifting capacity:	900 kg

Optional Equipment	
7708	Mounting plates (for welding coupling hooks)
7709	Mounting plate extension (increases total coupling width from 1150 to 1250 mm) (Coupling hooks can be welded directly to the frame when the distance between the coupling hooks (c/c) is 700-830 mm)
7710	Overhead arm
7712	Round bale spikes (2 pieces)
7714	3-point hitch category 2

Requires a double-acting hydraulic outlet.

Preparation of new equipment

Mount the grabbing arms. Tighten the nuts to 65-70 Nm torque. Note! The nut is eccentric. If the arms are not parallel, the axle in the arms must be rotated slightly before the nut is tightened again.

If mounting plates for coupling hooks (7708) are to be supplied, these are mounted on the frame. Plate extensions (7709) are used when the loader width exceeds approximately 1150 mm. The extensions are welded to the outer edge of the plate. The coupling hooks are welded to the mounting plates. If the loader width is 700-830 mm (c/c), the coupling hooks can be welded directly to the vertical frame beams.

If the bale grab is to be supplied with a 3-point hitch (7714), the pins are fastened to the lower part of the frame, while the tower is mounted in the opening at the top of the frame.

If the round bale grab is to be supplied with an overhead arm (7710), this is mounted in the opening at the top of the frame. The height is adjusted to fit the specific bale diameter.

Round bale spikes (7712) are mounted in place of the grabbing arms. Tighten the nuts to 65-70 Nm torque. Note! Eccentric nut, see point 1 above.

Connection to tractor

The round bale grab is connected to the front loader or 3-point hitch (remember correct attachment equipment). It is operated by the double-acting valve. The front loader should have a hydraulically adjustable attachment.

Use of the round bale grab

Align the grabbing arms parallel to the ground. Move the grabbing arms to the outer position before driving the grab into the bale.

If the round bale grab has an overhead arm (7710), lay it down on the bale. Press the arms underneath the bale so that it is securely held.

When stacking bales, ensure that the grabbing arms do not come into contact with nearby bales and damage the plastic wrapping.

When using the round bale spikes, two straw bales can be transported at the same time, but only one silage bale. Maximum load: 900 kg.

Maintenance

Avoid exposing the cylinder to an aggressive environment. Close the grabbing arms before long-term storage.

Keep the round bale grab clean. Avoid dirt on the hydraulic connections. Before long-term storage, protect shiny parts from rust.

Tighten the nuts on the grabbing arms/spikes after a day of use, and then once a week.

Lubrication

Joint bolts for grabbing arms (4 grease nipples) – grease every 10 hours.

Cylinder bolts – oil the bolts every week.

ROUND BALE GRAB UM 7705**FIG.1**

Ref.	Part No.	Qty	Item Description
1-11	411520	1	COMPLETE FRAME
1	411521	2	Frame, welded
2	411534	2*	Arm, welded L and R
3	373541	4	Grease nipple M6-45 GR.
4	411541	2	Axle Ø35x220-Ø16.5/16
5	313900	2	Hex screw M16x100-8.8 GALV.
5	352166	2	Nylock nut M16 GALV.
5	360166	2	Washer Ø17-Ø30x3
6	411540	2*	Spring
7	411542	1	Cylinder DV Ø63/Ø32x900+250
*	300833		Cylinder sealing kit Ø63/Ø32
8	873540	2	Grease nipple M6 Straight
9	411121	2	Hydraulic hose 3/8"2265
9A	410755	2	Quick coupling "male
9B	410747	2	Fitting 3/8"--" _ "BSP UU
9C	219669	2	O-ring "Bond Seal
9D	410724	1	Dust protector Blue
9E	410723	1	Dust protector Yellow
10	411538	2	Bolt
11	860181	4	Washer Ø31-Ø56x4
12	411539	2	Locking angle
13	866650	2	Clamping sleeve 12x50 ELZN
14-21	411505	2*	ROLLER SPINDLE COMPLETE
15	411507	1*	Axle
16	870752	3*	Ball bearing 6210-2RS
17	868614	1*	Support ring 70x90x3.5
18	869030	4*	Clamping ring EXT. 50x2.5
19	411508	1*	Complete tube
20	868590	1*	Internal locking ring
21	411573	1*	Nut
22	411574	1	Key
23	911299	1*	End plug 90x90
24	911296	1	End plug 60x60
25	411591	2	Roller spindle welded
26	241162	2	Tine
27	201200	2	Nut
28	411588	2	Washer
29	812166	2	Nylock nut M16 GALV.

*Parts marked with * have been modified since 2000.04.01

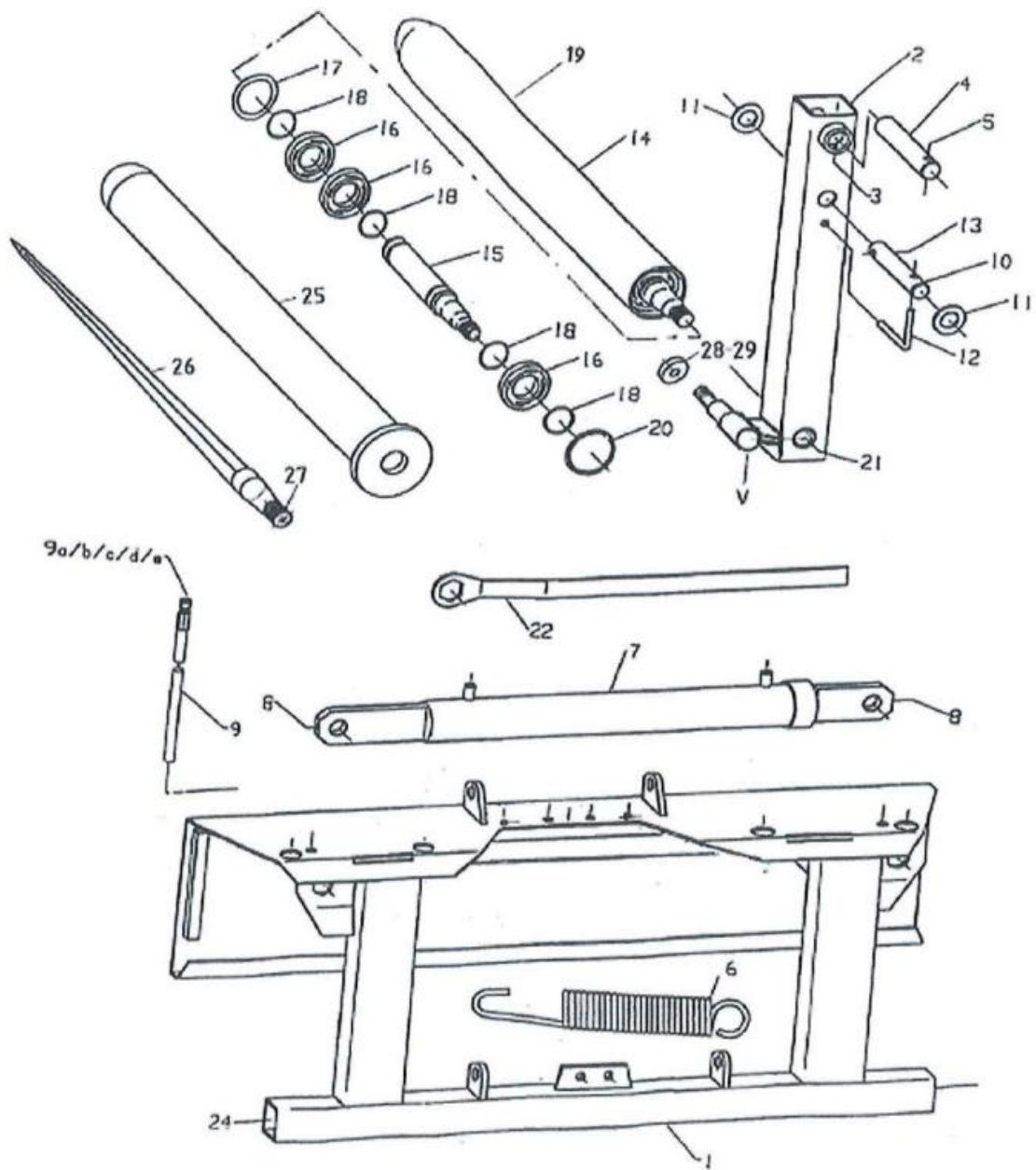

Fig. 1

ROUND BALE GRAB UM 7005**FIG. 2**

Ref.	Part No.	Qty	Item Description
1A-B	7712		ROUND BALE SPIKES
1A+B	411504	2	Tine
1B	411573	1	Nut
2-6	7710		COMPL. OVERARM
2	411560	1	Overarm mounting
3	813630	6	Hex screw M12x30-8.8 GALV
3	852162	4	Nylock nut M12 GALV
3	860163	2	Washer Ø13-Ø24x2.5
4	411545	1	Welded overarm
6	813901	1	Hex screw M16x110-8.8 GALV
6	852166	1	Nylock nut M16 GALV
6	860166	1	Washer Ø17-Ø30x3
14	411596	1	Support plate
7-9	7711		TOP LINK MOUNTING FOR OVERARM
7	411554	1	Top link mounting welded
8	411559	1	Clamping plate Ø13-100-80
9	813702	4	Hex screw M12x120-8.8 GALV
9	860163	4	Washer Ø13-Ø24x2.5
9	852162	4	Nylock nut M12 GALV
10	411565	1	Left pull bar mounting welded
11	411566	1	Right pull bar mounting welded
12	411572	2	Clamp 4KT 101.5-M16
13	852166	4	Nylock nut M16 GALV

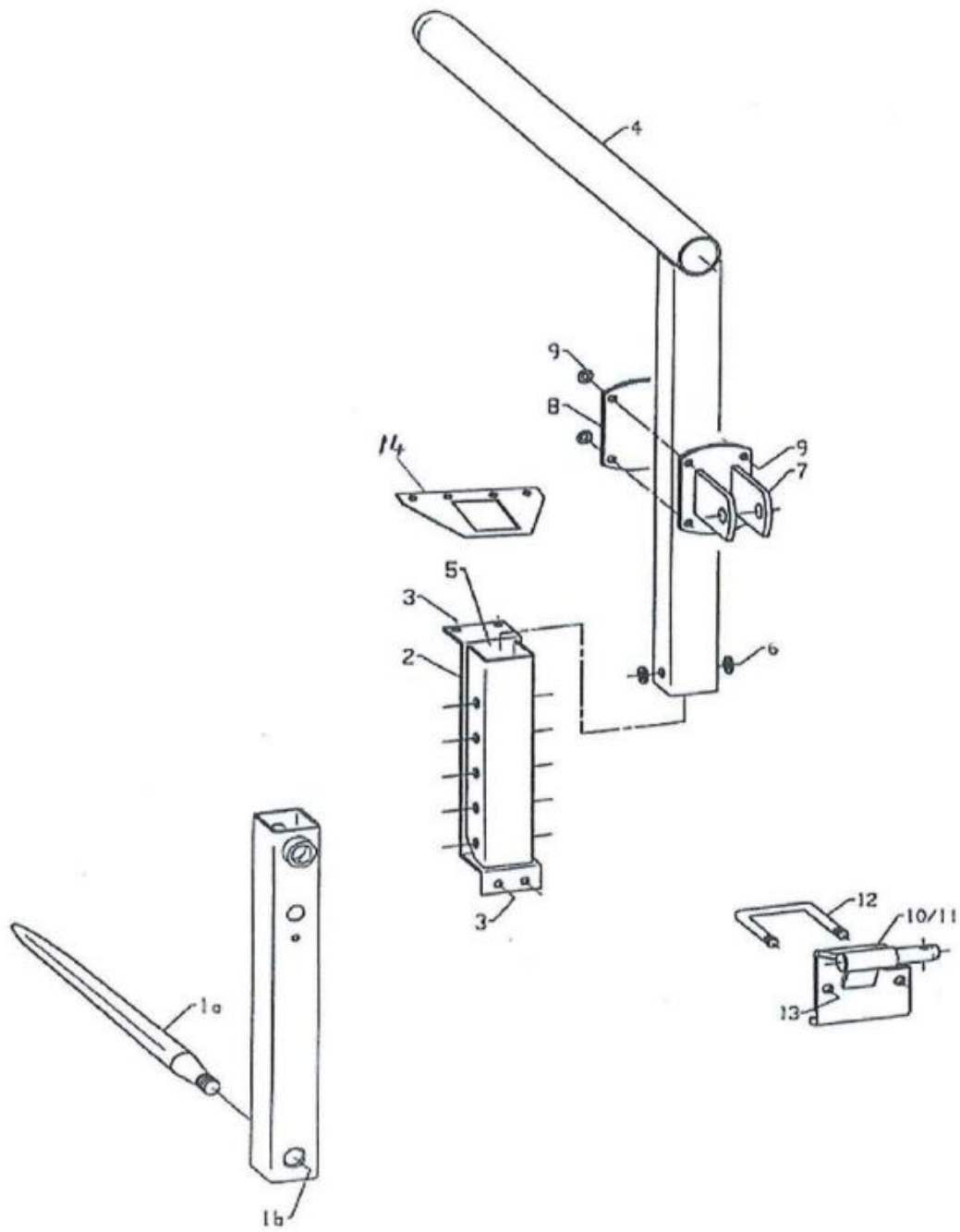

Fig. 2

ROUND BALE GRAB UM 7705**FIG.3**

Ref.	Part No.	Qty	Item Description
1-6	7714	1	THREE-POINT LINKAGE KIT
1	411555	1	Top link mounting welded
2	813630	6	Hex screw M12x30-8.8 GALV
2	852162	6	Nylock nut M12 GALV
2	860163	2	Washer Ø13-Ø24x2.5
3	911298	1	End plug 80x80
4A	411566	1	Right pull bar mounting welded
4B	411565	1	Left pull bar mounting welded
5	411572	2	Clamp 4KT. 101.5-M16
6	852166	4	Nylock nut M16 GALV
12	411596	1	Support plate
7-10	7708	1	COMPLETE MOUNTING PLATES
7A	411575	1	Left mounting plate
7B	411576	1	Right mounting plate
8	411572	2	Clamp 4KT. 101.5-M16
9	814050	4	Hex screw M20x50-8.8 GALV
9	852167	4	Nylock nut M20 GALV
10	852166	4	Nylock nut M16 GALV
	7709	1	MOUNTING PLATE EXTENSION
11	411578	2	Mounting plate extension

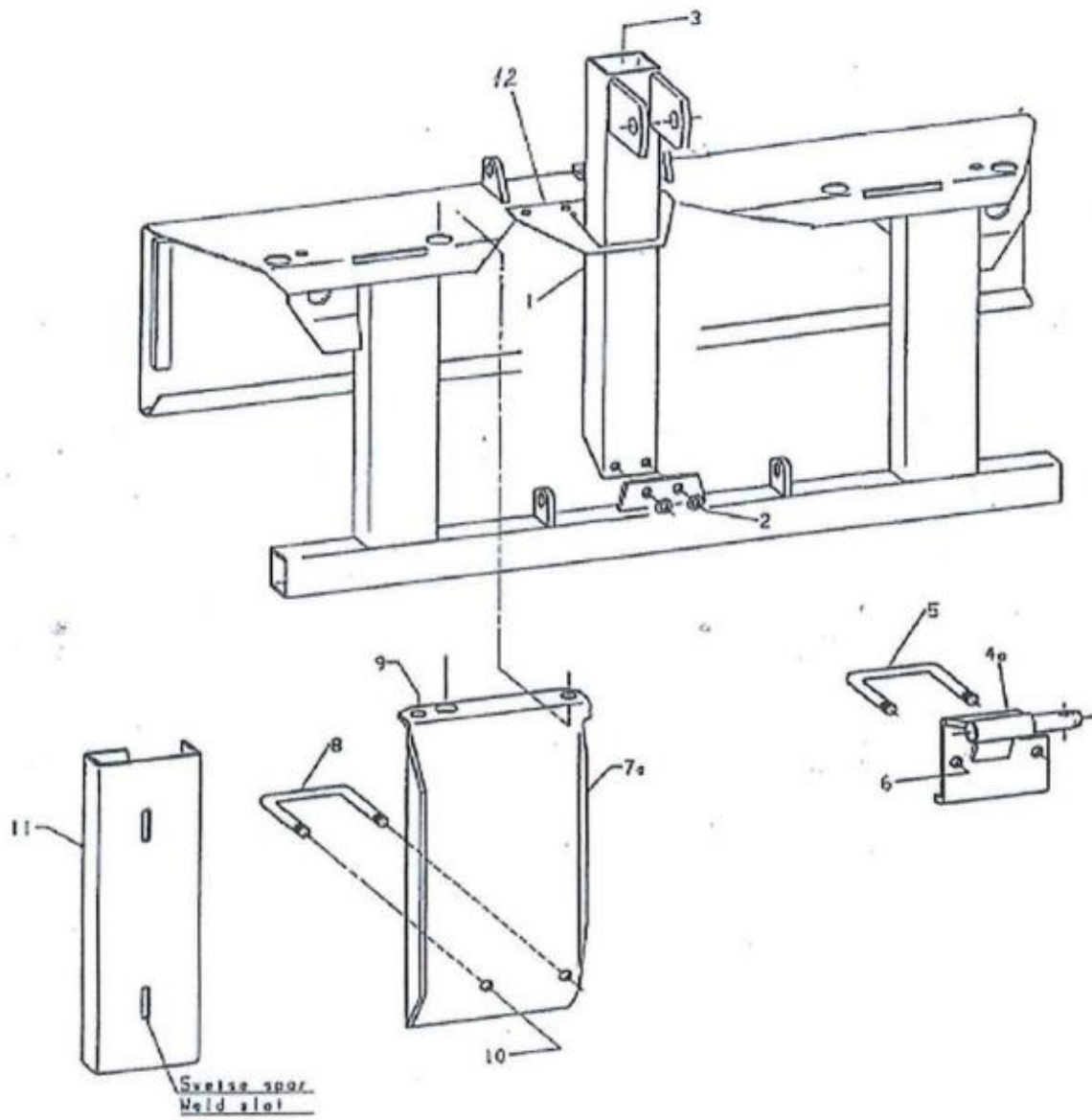

Fig. 3



EU - DECLARATION OF CONFORMITY

Responsible person

Name	Atle Årsland
Position	General Manager
Company	Underhaug AS
Address	Torlandsvegen 3 4365 Nærbø, NORWAY
Phone	+47 51 43 49 78

Declares that the following machine:

Manufacturer:	Underhaug AS
Type:	<i>UM 7005 Round bale handler</i>
Serial Number:	
Production Year:	

complies with the following directive:

Maximum regulation 554 (for 2009-05-20-554) and meets essential health and safety requirements.

Basic standard ISO 12100

A handwritten signature in blue ink, reading "Atle Årsland".

Atle Årsland

Nærbø, date



Torlandsvegen 3 – P.Box 183
N-4367 Nærbø, Norway
Phone: +47 51 43 49 78
Email: post@underhaug.no

www.underhaug.no/eng